

# chapterPRO<sup>®</sup>

## Mobile Web App Instructions for Your Chapter

Device: **Android**  
Browser: **Chrome**  
Support: [support@chapterpro.com](mailto:support@chapterpro.com)

- 1 Tap Chrome.   
Enter your site's web address.  
Tap blue search icon.

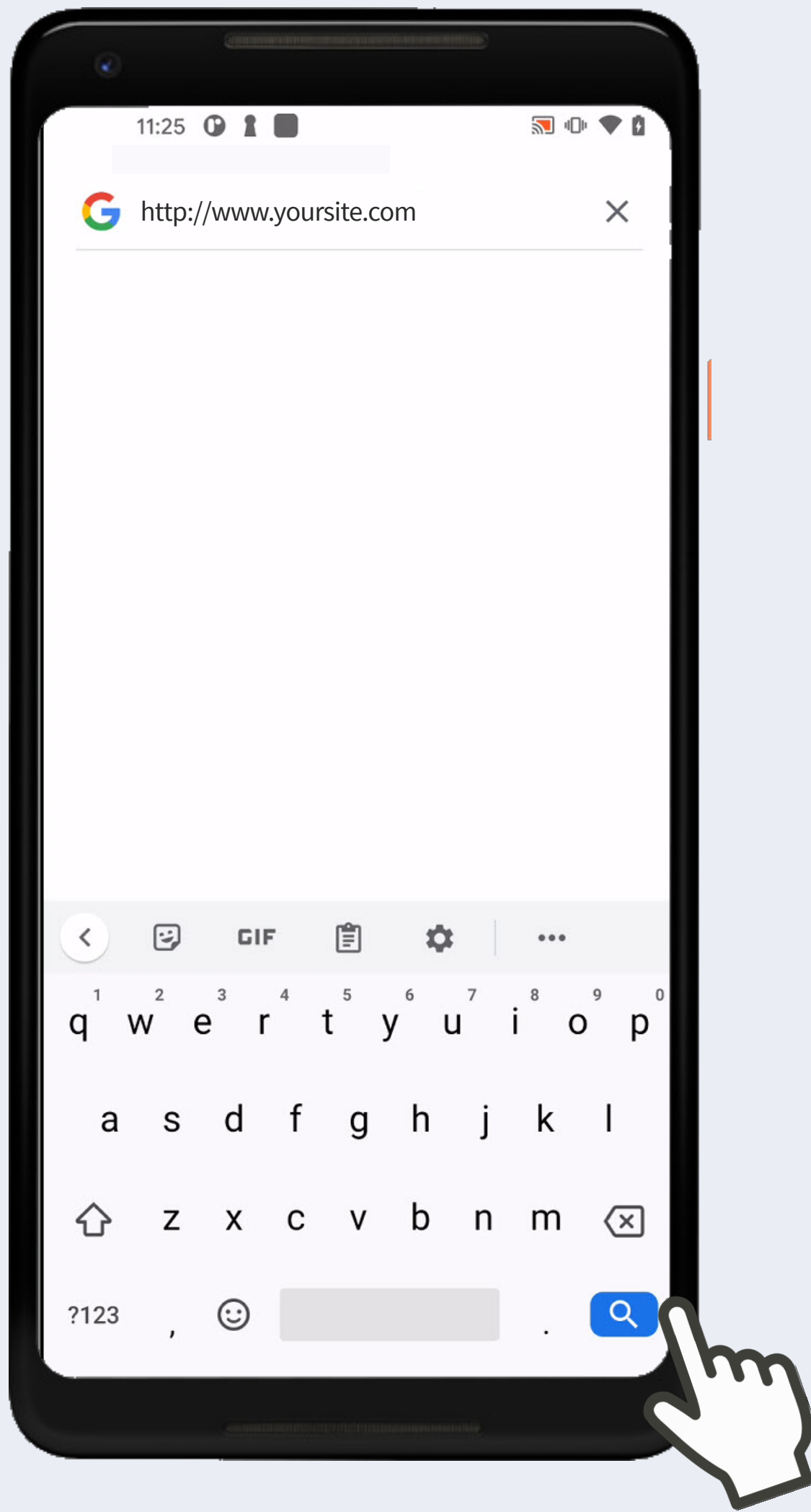

- 2 If you have a public site, tap Menu. Then tap Login.  
If not, skip to #3.

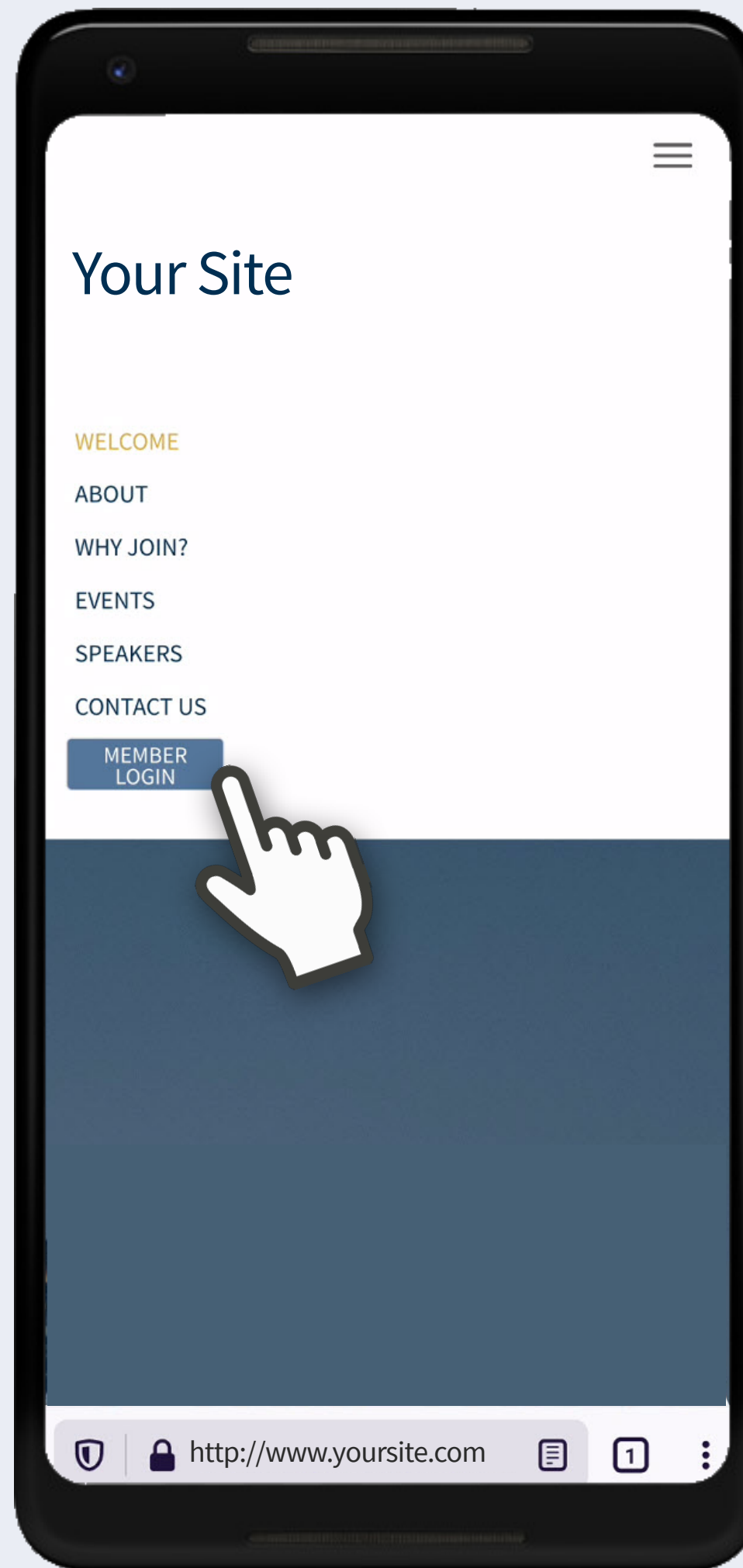

- 3 Tap Mobile App.

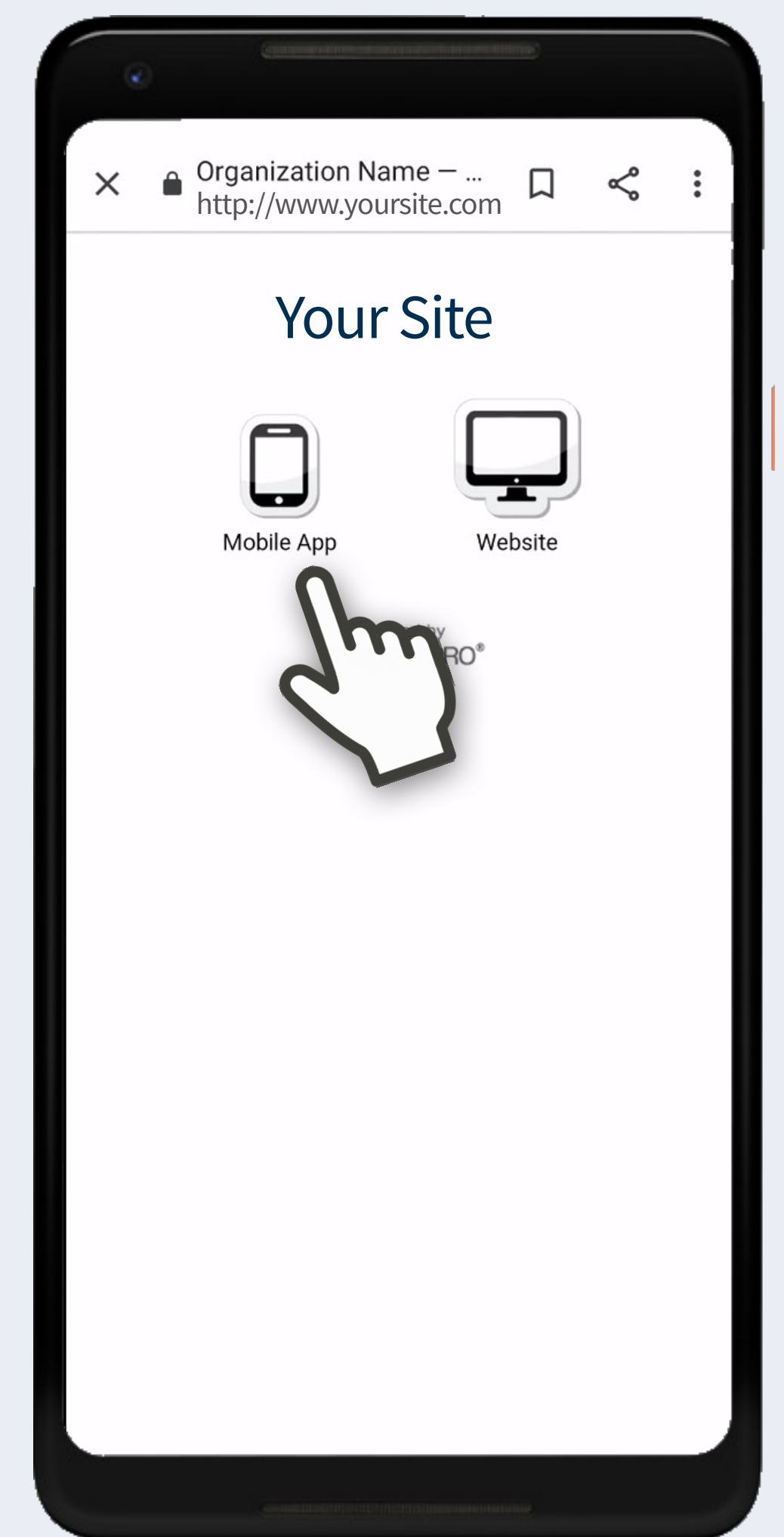

- 4 **Do not login at this time.** Tap 3 dots in the bottom middle.

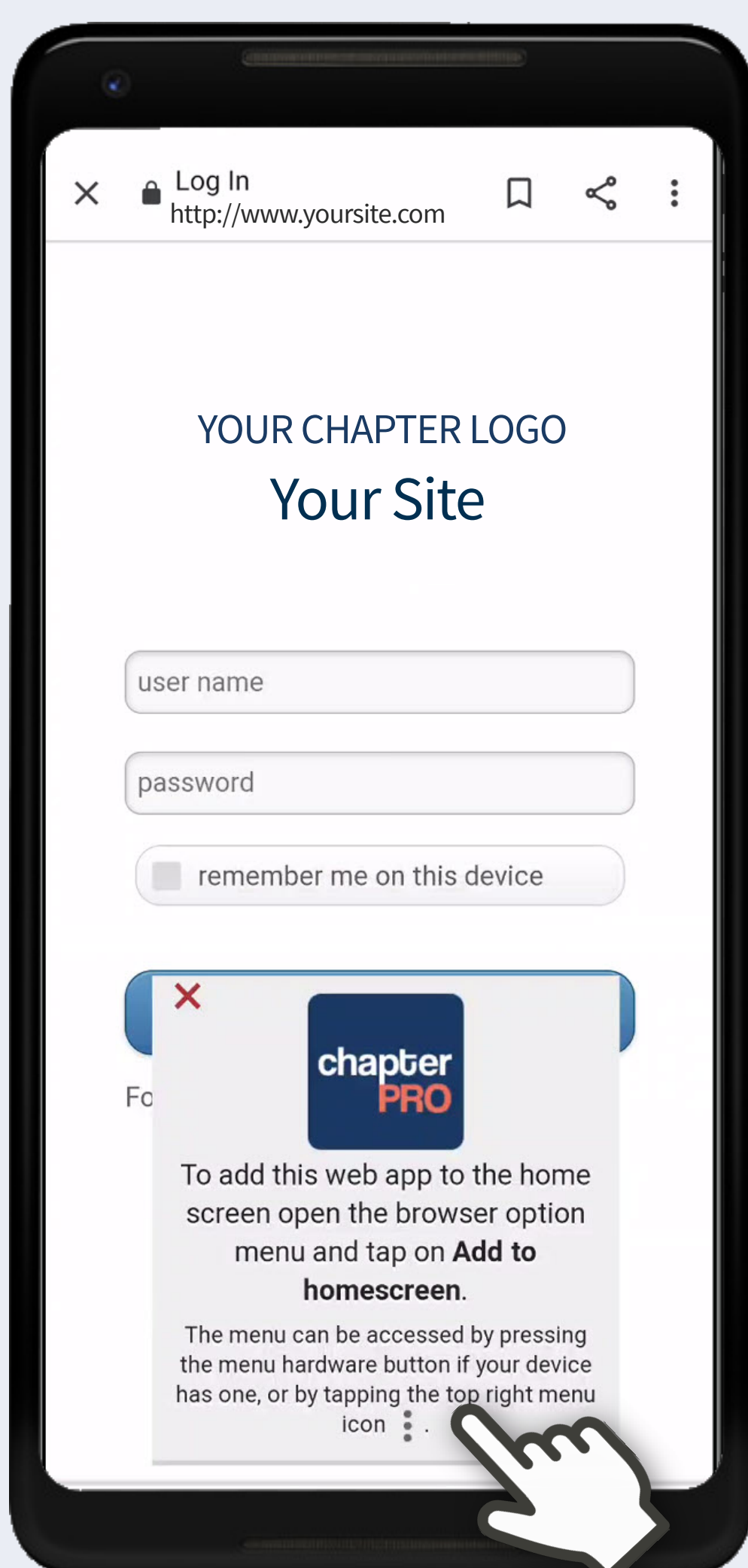

- 5 Tap Add to Home screen.

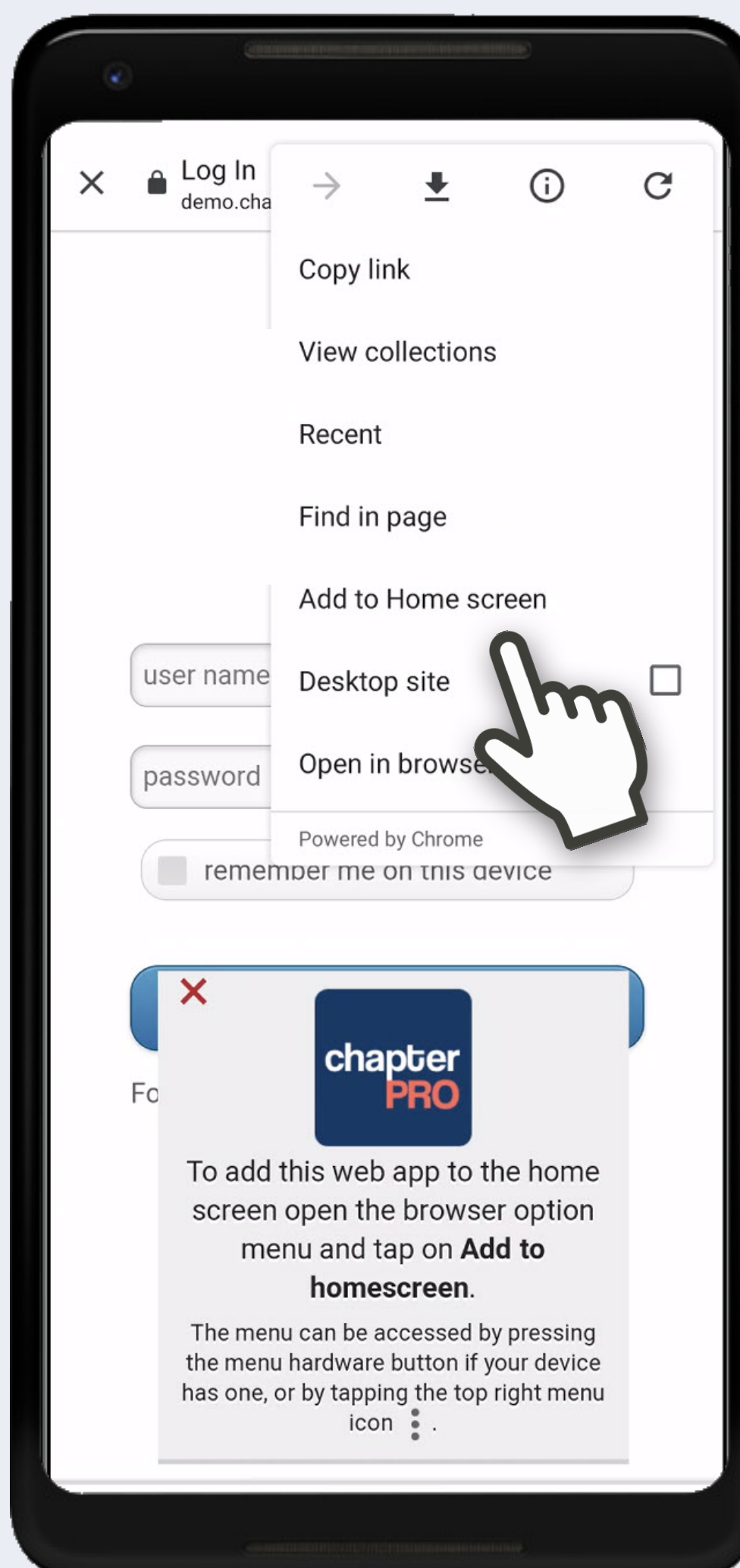

- 6 Change Log In to your organization's name.  
Tap Add.

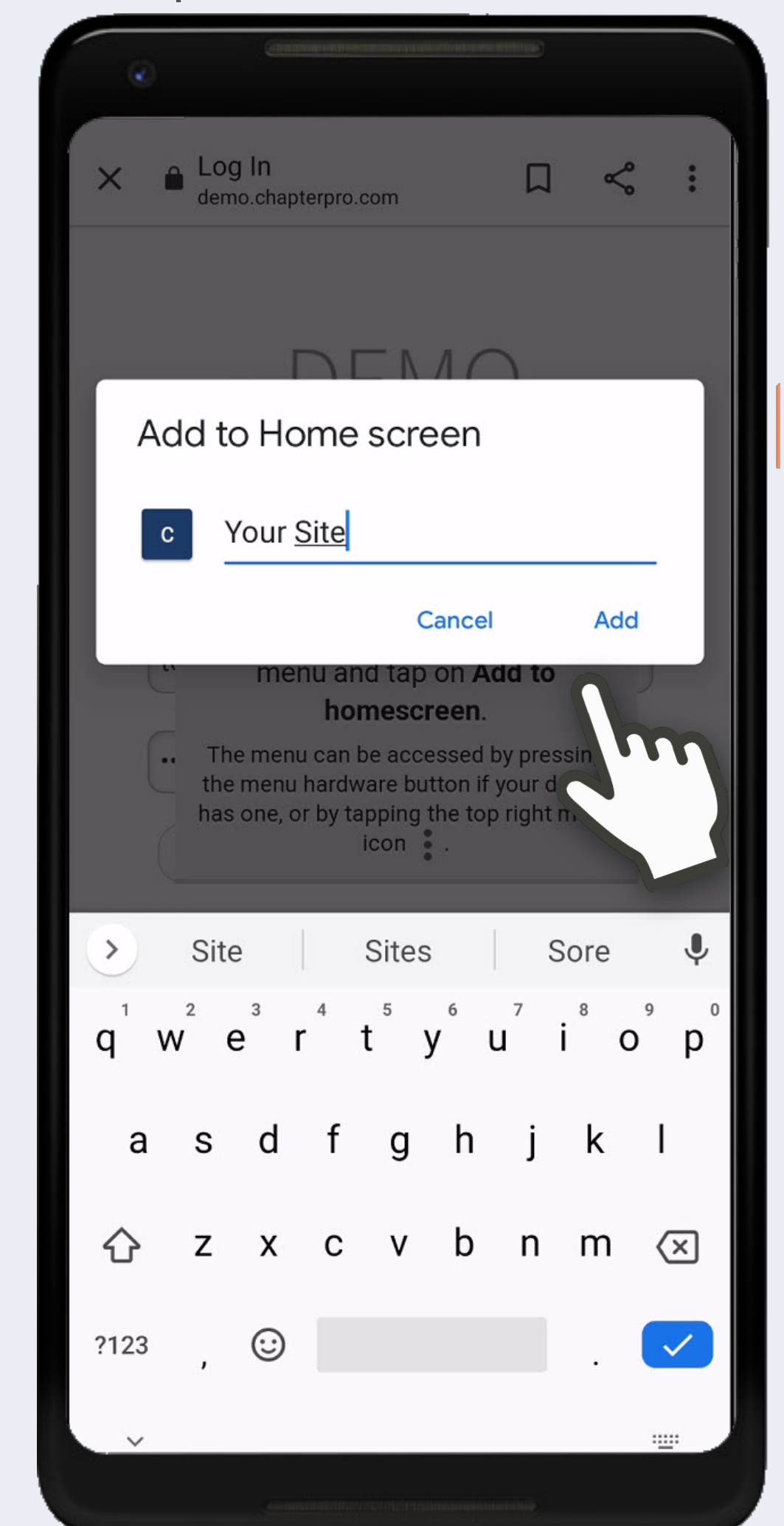

# chapterPRO®

## Mobile Web App Instructions for Your Chapter

Device: **Android**  
Browser: **Chrome**  
Support: [support@chapterpro.com](mailto:support@chapterpro.com)

7 Tap Add automatically.

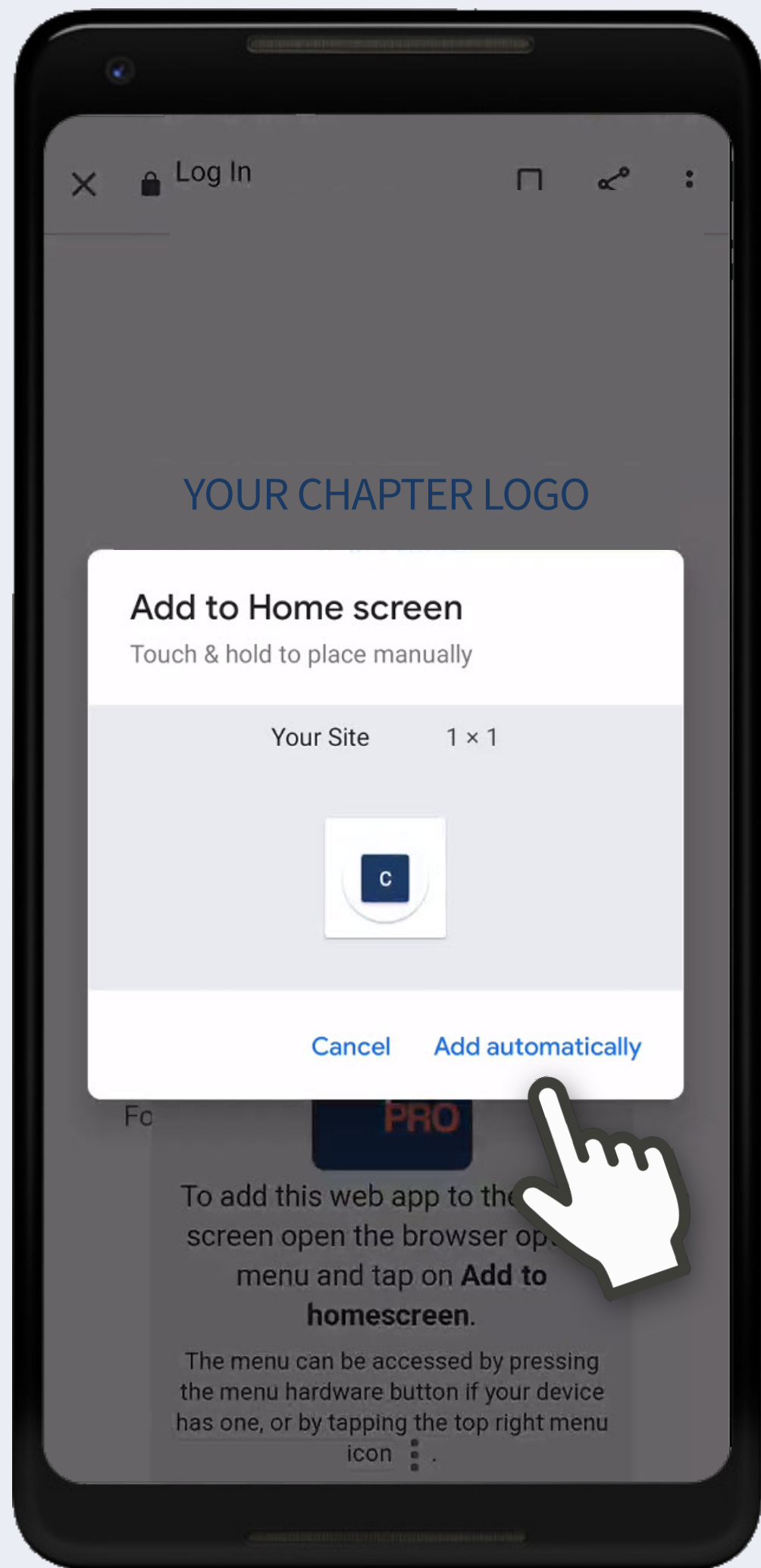

8 Enter user name & password. *Optional: check remember me on this device.* Tap Log In.

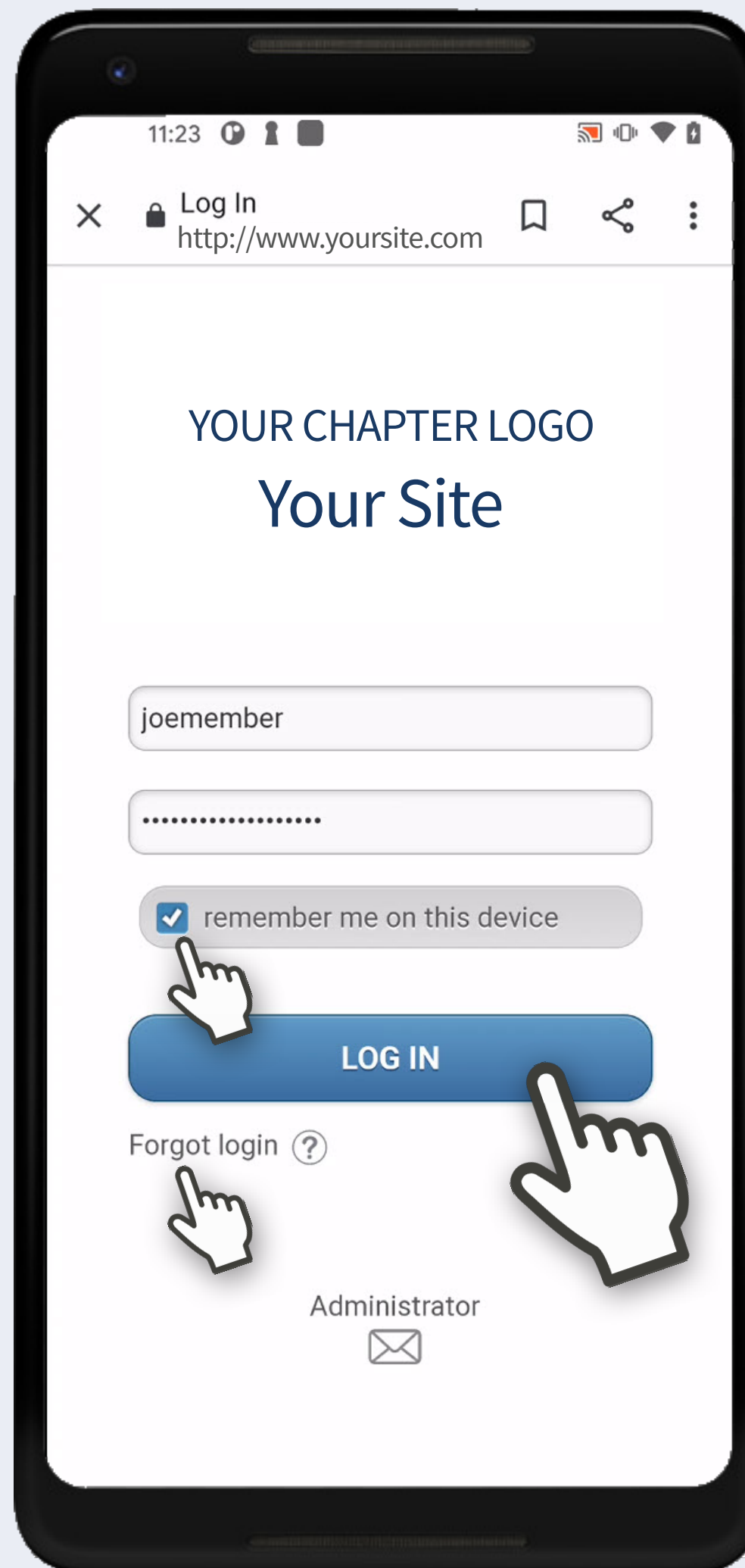

## You're In!

On Calendar, tap event title to view details & attendees, and RSVP. Swipe for previous/next.

Tap Members to view member directory. Use search or scroll.

Tap Member Name to view contact screen and tap to Phone, Text or Email. Swipe for previous/next.

Tap Menu to access all other info.

